



Panasonic

Basic Operating Instructions Základní pokyny k obsluze Podstawowa instrukcja obsługi Home Theater Audio System Sestava pro domácí kino Zestaw audio do kina domowego Model No. SC-HTB490

Thank you for purchasing this product.
For optimum performance and safety, please read these instructions carefully.
Please keep this manual for future reference.

Děkujeme za zakoupení tohoto výrobku.
Pro dosažení optimálního výkonu a z bezpečnostních důvodů si pečlivě přečtěte tyto pokyny.
Uschovejte si prosím tento návod k obsluze.

Dziękujemy za zakupienie tego produktu.
Proszę dokładnie zapoznać się z tą instrukcją obsługi, aby jak najlepiej wykorzystać to urządzenie i zapewnić jego bezpieczne użytkowanie.
Prosimy o zachowanie niniejszej instrukcji obsługi.

REGISTER NOW



UPDATES TIPS



NEWS



OFFERS

www.panasonic.eu/register

This manual contains basic information. Visit website below for detailed instructions.
Tato příručka obsahuje základní informace. Podrobné pokyny naleznete na webové stránce níže.
Poniższy podręcznik zawiera podstawowe informacje. Szczegółowe instrukcje można znaleźć na stronie internetowej.



https://panasonic.jp/support/global/cs/audio/oi/sc_htb490/

Manufactured by: Panasonic Corporation
Kadoma, Osaka, Japan
Authorized Representative in Europe: Panasonic Marketing Europe GmbH
Panasonic Testing Centre
Winsberg 15, 22525 Hamburg, Germany



Panasonic Corporation
Web Site: <http://www.panasonic.com>



72-H490EG-QSGB3

TQBJ2334

L0121CH1021

English

Your system and the illustrations can look differently
The symbols on this product (including the accessories) represent the following:

- ~ AC
- Class II equipment (The construction of the product is double-insulated.)
- | ON
- Standby

Safety precautions

WARNING

Unit

- To reduce the risk of fire, electric shock or product damage,
 - Do not expose this unit to rain, moisture, dripping or splashing.
 - Do not place objects filled with liquids, such as vases, on this unit.
 - Use the recommended accessories.
 - Do not remove covers.
 - Do not repair this unit by yourself. Refer servicing to qualified service personnel.
- To prevent injury, this unit must be securely attached to the wall in accordance with the installation instructions.

AC mains lead

- To reduce the risk of fire, electric shock or product damage,
 - Ensure that the power supply voltage corresponds to the voltage printed on this unit.
 - Insert the mains plug fully into the socket outlet.
 - Do not pull, bend, or place heavy items on the lead.
 - Do not handle the plug with wet hands.
 - Hold onto the mains plug body when disconnecting the plug.
 - Do not use a damaged mains plug or socket outlet.

Small objects

- Keep the screws and insulation sheet (battery) out of reach of children to prevent swallowing.

Button-type battery (Lithium battery)

- Risk of fire, explosion and burns. Do not recharge, disassemble, heat above 60°C or incinerate.



WARNING
DO NOT INGEST BATTERY,
CHEMICAL BURN HAZARD

This remote control contains a coin/button cell battery. If the coin/button cell battery is swallowed, it can cause severe internal burns in just 2 hours and can lead to death. Keep new and used batteries away from children. If the battery compartment does not close securely, stop using the remote control and keep it away from children. If you think batteries might have been swallowed or placed inside any part of the body, seek immediate medical attention.

CAUTION

Unit

- To reduce the risk of fire, electric shock or product damage,
 - Do not install or place this unit in a bookcase, built-in cabinet or in another confined space. Ensure this unit is well ventilated.
 - Do not obstruct this unit's ventilation openings with newspapers, tablecloths, curtains, and similar items.
 - Do not place sources of naked flames, such as lighted candles, on this unit.
- This unit is intended for use in moderate climates.
- This unit may receive radio interference caused by mobile telephones during use. If such interference occurs, please increase separation between this unit and the mobile telephone.
- Set the unit up on an even surface away from direct sunlight, high temperatures, high humidity, and excessive vibration.
- This system might get warm after prolonged usage. This is normal. Do not be alarmed.

AC mains lead

- The mains plug is the disconnecting device. Install this unit so that the mains plug can be unplugged from the socket outlet immediately.

Button-type battery (Lithium battery)

- Danger of explosion if battery is incorrectly replaced. Replace only with the type recommended by the manufacturer.
- When disposing of the batteries, please contact your local authorities or dealer and ask for the correct method of disposal.
- Do not heat or expose to flame.
- Do not leave the battery(ies) in a car exposed to direct sunlight for a long period of time with doors and windows closed.
- Insert with poles aligned.
- Remove the battery if you do not use the remote control for a long period of time. Keep in a cool, dark area.

Declaration of Conformity (DoC)

Hereby, "Panasonic Corporation" declares that this product is in compliance with the essential requirements and other relevant provisions of Directive 2014/53/EU.

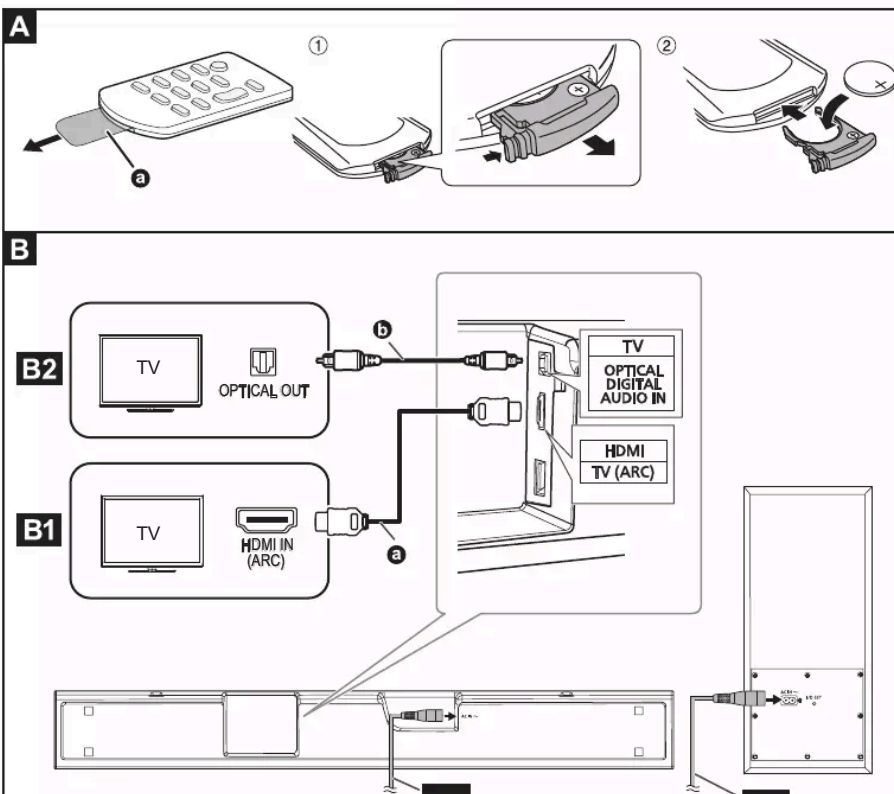

Supplies

- 1 Main
- 1 Active
- 2 AC m
- 1.5 m For
- 1.2 m For
- 1 Remo
- (N2QAYC
- 1 Wall
- 1 Wall
- 2 Screws

A Prep

Before using

Remove the

Insulation

Replacing the

Replace with

Insert a new

Caution

Avoid the u

• High or low

transporta

• Replacem

• Disposal o

mechanica

that can re

• Extremely

pressure f

or the lea

B Con

Switch off all

Components

Connect the

connections

Connecti

B1 Conn

Connect to th

ARC compat

HDMI cab

ARC (Audio

ARC is an H

TV picture

cable that i

a TV is no l

B2 Conn

When conn

orientation a

Optical di

Connecti

To house

Note:

The active su

mains lead is

long as the A

C Con

Standby/c

Press to

versa. In

amount

Adjust the

Select the

On the m

TVBI

To start

AIRI

Indicator A

The indic

dependin

Indicator B

The indic

dependin

Remote c

Point the

away fro

Distance

Angle: Ap

WIRELES

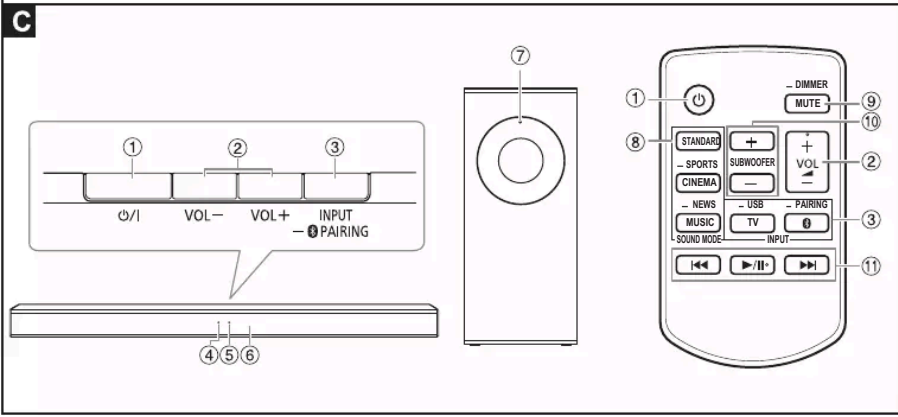

Customers can download a copy of the original DoC to our RE products from our DoC Server: <http://www.ptc.panasonic.eu>
 Contact to Authorised Representative:
 Panasonic Marketing Europe GmbH, Panasonic Testing Centre, Winsbergring 15, 22525 Hamburg, Germany

- ⑧ Select the
- ⑨ Mute the s
Dim the l
- ⑩ Select the
- ⑪ USB and f

| Type of wireless | Frequency band | Maximum power (dBm E.I.R.P.) |
|--|-----------------|------------------------------|
| Bluetooth® (Main unit) | 2402 – 2480 MHz | 10 dBm |
| 2.4 GHz wireless system (Main unit and active subwoofer) | 2404 – 2476 MHz | 10 dBm |

- Play Pre
- Pause P
- Skip Pre

